

ISO Pipe - Ø125mm x 2m

(insulated duct with female/female connectors)



MODELS

Part no	Description
9041147	Ø125mm x 2m ISO Pipe
9041154	Ø125mm 45° ISO Bend
9041152	Ø125mm 90° ISO Bend

DIMENSIONS

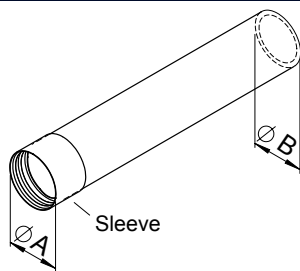

Ø125 mm x 2 m - A 158 mm B 157 mm

KEY FEATURES

- Thermally insulated ductwork for air distribution system
- Quick and easy assembly
- Tough, durable and anti-static EPE (expanded polyethylene)
- Fire retardant to B2
- Avoids condensation build up
- Sound absorbing smooth bore pipe
- Choice of components to suit any layout

SPECIFICATION:

- Thickness: 15 mm
- Material density: 60g/dm³, antistatic
- Thermal conductivity: 0.042 W/mK
- Application range: -25 °C to +80 °C
- Elasticity: 30% DIN 52612

PERFORMANCE

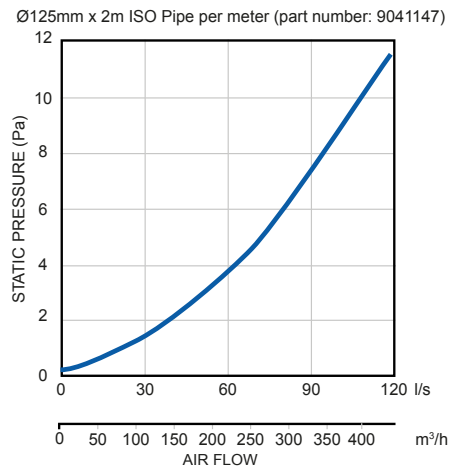

All ISO Pipe moulded ducts and bends are precisely matched and compatible with each other, installing them with a simple connection. ISO Pipe is fast to install and could save up to 70% installation time. All pipe parts are fully insulated and prevent condensation due to the antistatic EPE. With a smooth, sound-absorbing inner surface, ISO pipe is easy to clean and maintain.

The ISO pipe design concept and installation is especially suitable for intake air and exhaust air ducting or supply air and extract air ducting connected to mechanical ventilation with heat recovery units. Other benefits include vibration-proof, particularly lightweight and easily adjusted by shortening the pipe according to the length required.



Ø125mm 45° ISO Bend

Ø125mm 45° insulated duct bend with a male connector for ducting runs in unheated voids that require insulation. Made of vapour-tight and antistatic EPE (expanded polyethylene).



PERFORMANCE

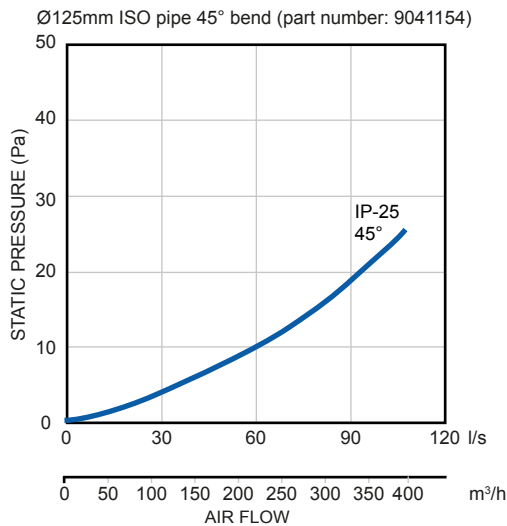

KEY FEATURES

- Arrives insulated and ready to use
- Quick and simple assembly with only one step for connection
- Tough, durable, anti-static EPE focused on smooth airflow performance
- Avoids condensation build up in a duct system and helps to comply with building regulations
- Sound absorbing, smooth bore pipe with limited inner surface resistance made of high quality material
- Versatile choice of components to suit any layout
- All round insulation solution suited to most applications

SPECIFICATION:

- Thickness: 15 mm
- Material density: 60g/dm³, antistatic
- Thermal conductivity: 0.042 W/mK
- Application range: -25 °C to +80 °C
- Elasticity: 30% tested to DIN 52612

DIMENSIONS

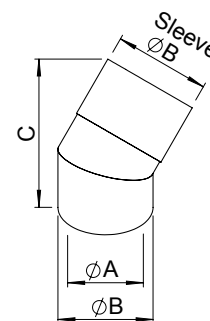

A 125 mm B 157 mm C 255 mm

Ø125mm 90° ISO Bend

Ø125mm 90° insulated duct bend with a male connector for ducting runs in unheated voids that require insulation. Made of vapour-tight and antistatic EPE (expanded polyethylene).



PERFORMANCE

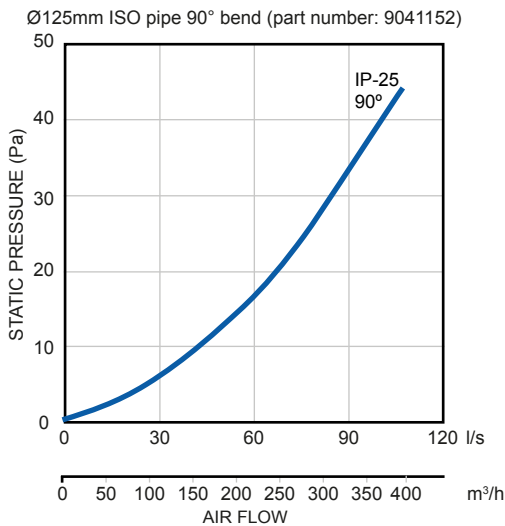

ACCESSORIES



Ø125mm ISO Collar
No: 9041149
Ø125mm ISO collar with female spigots for connecting Ø125mm ISO duct lengths.



Ø160mm to 125mm Metal Pipe Connector
No: 90000470
Ø160mm male with seal to Ø125mm female steel connector.



6-Port In-Line Flat Distribution Box
No: 90000264
Acoustic lined 6-Port in-Line Distribution Box for AirflexPro Semi-rigid duct systems, ready for Ø125mm ISO pipe connection.
For AirflexPro Round



125mm Round Cowl Mesh
No: 9041228
A weather resistant stainless steel round cowl with louvres suitable for air intake or discharge. To be used with a 125mm diameter connection.

KEY FEATURES

- Arrives insulated and ready to use
- Quick and simple assembly with only one step for connection
- Tough, durable, anti-static EPE focused on smooth airflow performance
- Avoids condensation build up in a duct system and helps to comply with building regulations
- Sound absorbing, smooth bore pipe with limited inner surface resistance made of high quality material
- Versatile choice of components to suit any layout
- All round insulation solution suited to most applications

SPECIFICATION:

- Thickness: 15 mm
- Material density: 60g/dm³, antistatic
- Thermal conductivity: 0.042 W/mK
- Application range: -25 ° C to +80 ° C
- Elasticity: 30% tested to DIN 52612

DIMENSIONS

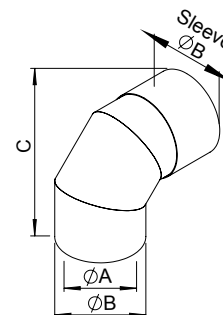

A 125 mm B 157 mm C 239 mm

TECHNICAL INFORMATION

ISO pipe can satisfy airflow requirements listed in part F when paired with our MVHR units and offers up to 70% in-site time saved.

Technical Specification	Value
Thermal Conductivity	0.042 W/mK
Operating Airflow Temperatures	-25 to 80 °C
Fire Rating	B1 or B2 Rating*
Max Airflow capacity	138.8 l/s
Material	Anti Static polyethylene Foam or brushed steel
Inner Material	Smoothbore, with airtight seals and connectors
Length per pipe	2000 mm
Spigot Compatibility	Ø125 mm, Ø160 mm, Ø180 mm, Ø200 mm
Connection	Watertight, airtight
Testing Certificates	EN 13501-1, DIN 4102, DIN 52612-2

*external connectors are rated at B2

Our ISO ducting range complies to several key conditions in the UK and EU building regulations:

Complies to approved Document B (Fire safety) – Volume 1: Dwellings (2019 edition)

Easily enables a system to achieve the airflow rates in part F approved document table 5.1a and 5.1b.

ISO Ducting can be used to meet the recommendations for ductwork listed in ventilation compliance guide table 7 - 2.0, sections a, b, c, d and section 2.0 (ductwork continued 1) a, b, c, d, e and f.

CONNECTIONS AND FITTINGS

Please refer to the diagrams below for an explanation of how an ISO pipe system works together.

Figure 1: Reducer



Male and Female Reducers

Male connections feature a gasket to ensure an airtight seal when inserted into ISO ducting. The female socket pushes over the gasket on the distribution box.

Figure 2: Internal and External Connections

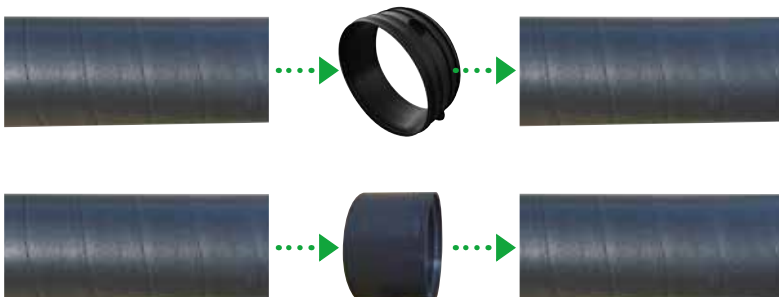

External and Internal connections

125 mm connections are facilitated exclusively by external connections, connections for larger sizes are facilitated exclusively by internal connections. Both offer identical performance.

TECHNICAL INFORMATION CONTINUED

EFFICIENT

With airflow rates up to 138.8 l/s and thermal conductivity of 0.042 W/mK combined with resistance to air temperatures of -25 to 80 °C. This duct can deliver on the performance you need for airflow MVHR units and enable you to offer a solution for insulation requirements. Its smooth bore inner surface is not only sound absorbing but helps make maintenance an ease. The ISO duct is antistatic which will prevent build-up of dust particles and keep maintenance of the pipe hassle free.

EASY

ISO Pipe can save up to 70% of assembly time compared to other products on the market and is quick to mount with all components compatible with connectors, collars, elbows, and adapters for going from smaller to larger diameters and vice versa. These products have been designed to be airtight and quickly connected for an easy installation process. The in-built internal connectors can be

unpacked and screwed on without hassle. With a high crushability resistance, the robust duct ensures a low chance of damage on site.

SAFE

Our ISO ducting is made of polyethylene foam which is watertight, anti-static and an insulator. This material has been fire tested to German standard DIN 4102 and British Standard EN 13501-1, achieving a B1 rating which is compliant to Part B building regulations.

The process for classification under this standard involves a combination of up to five rigorous tests designed to assess the product on a range of characteristics, including combustibility, heat levels, flame spread and smoke release, this rating means this product has "limited contribution to fire spread". Expanded polyethylene (EPE) is resistant to condensation forming in the duct which could result in water unsafely entering electrical equipment.

TECHNICAL INFORMATION CONTINUED

- Pre-insulated one-piece.
- Quick and easy assembly.
- Tough, durable, anti-static EPE and Steel.
- Fire retardant to B1 and B2.
- Avoids condensation build up.
- Sound absorbing, smooth bore pipe.
- Choice of components to suit any layout.
- Compatible with Airflow MVHR to deliver on performance and reliability.
- Reliable ductwork with good crushability characteristics.
- Easy maintenance.
- Hassle free connection on site.

Note: External connectors are only available in $\phi 125$ mm size, and offer identical performance to internal connectors.

**ISO Pipe
(Internal Connection)**

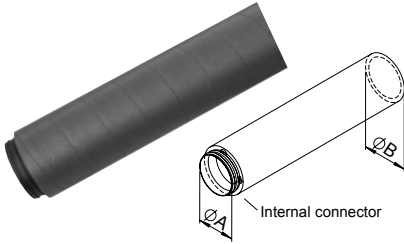

Part Number - 90000465
 $\phi 160 \times 2000$ mm - A 160 mm B 192 mm
Part Number - 90000475
 $\phi 180 \times 2000$ mm - A 180 mm B 212 mm
Part Number - 90001277
 $\phi 200 \times 2000$ mm - A 200 mm B 232
 Comes with internal plastic connector.

**ISO Pipe
(External Connection)**

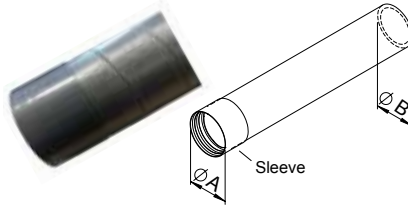

Part Number - 9041147
 $\phi 125 \times 2000$ mm - A 158 B 157 mm
 Comes with external plastic connector.

ISO Pipe

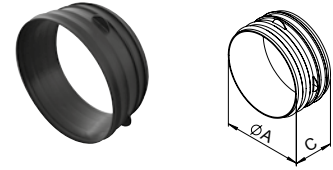

Part Number - 90000468
 $\phi 160$ mm - A 160 mm C 80 mm
Part Number - 90000478
 $\phi 180$ mm - A 180 mm C 80 mm
Part Number - 90001362
 $\phi 200$ mm - A 200 mm C 80 mm
 Internal plastic connector for ISO pipes.

ISO 90° Degree Elbow

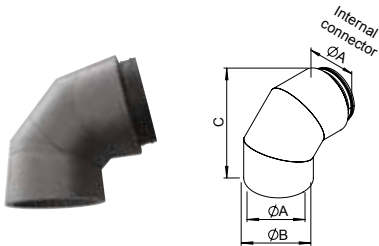

Part Number - 90000467
 $\phi 160$ mm - A 160 mm B 192 mm C 272 mm
Part Number - 90000477
 $\phi 180$ mm - A 180 mm B 212 mm C 292 mm
Part Number - 90001278
 $\phi 200$ mm - A 200 mm B 232 mm C 306 mm
 Comes with internal plastic connector.

ISO 45° Degree Elbow

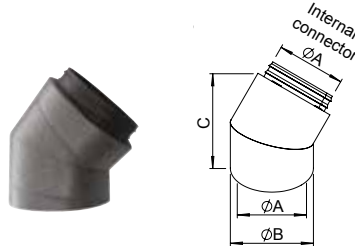

Part Number - 90000466
 $\phi 160$ mm - A 160 mm B 192 mm C 242 mm
Part Number - 90000476
 $\phi 180$ mm - A 180 mm B 212 mm C 256 mm
Part Number - 90001347
 $\phi 200$ mm - A 200 mm B 232 mm C 265 mm
 Comes with internal plastic connector.

**ISO Internal Connector
(Metal)**

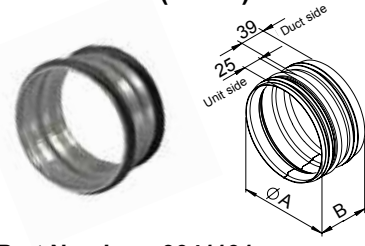

Part Number - 9041191
 $\phi 125$ mm - A 125mm B 70 mm
Part Number - 90000469
 $\phi 160$ mm - A 160 mm B 70 mm
Part Number - 9041232
 $\phi 200$ mm - A 200 mm B 88 mm
 Internal metal connector with airtight seals.

ISO 90° Degree Elbow

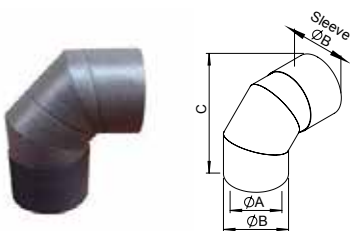

Part Number - 9041152
 $\phi 125$ mm
 - A 125 mm B 157 mm C 239 mm
 Comes with external plastic connector.

ISO 45° Degree Elbow

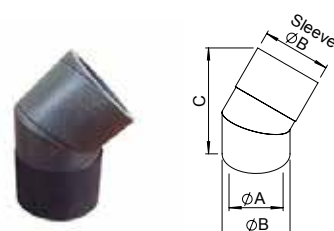

Part Number - 9041154
 $\phi 125$ mm
 - A 125 mm B 157 mm C 255 mm
 Comes with external plastic connector.

**ISO External Connector
(Plastic)**

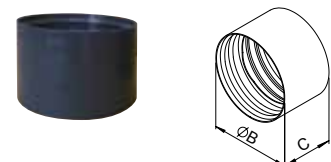

Part Number - 9041149
 $\phi 125$ mm
 - B 157 mm C 104 mm
 External connector for 125 mm ISO duct plastic.

Call: 01494 525252

Visit: airflow.com