

INSTALLATION AND OPERATING INSTRUCTIONS

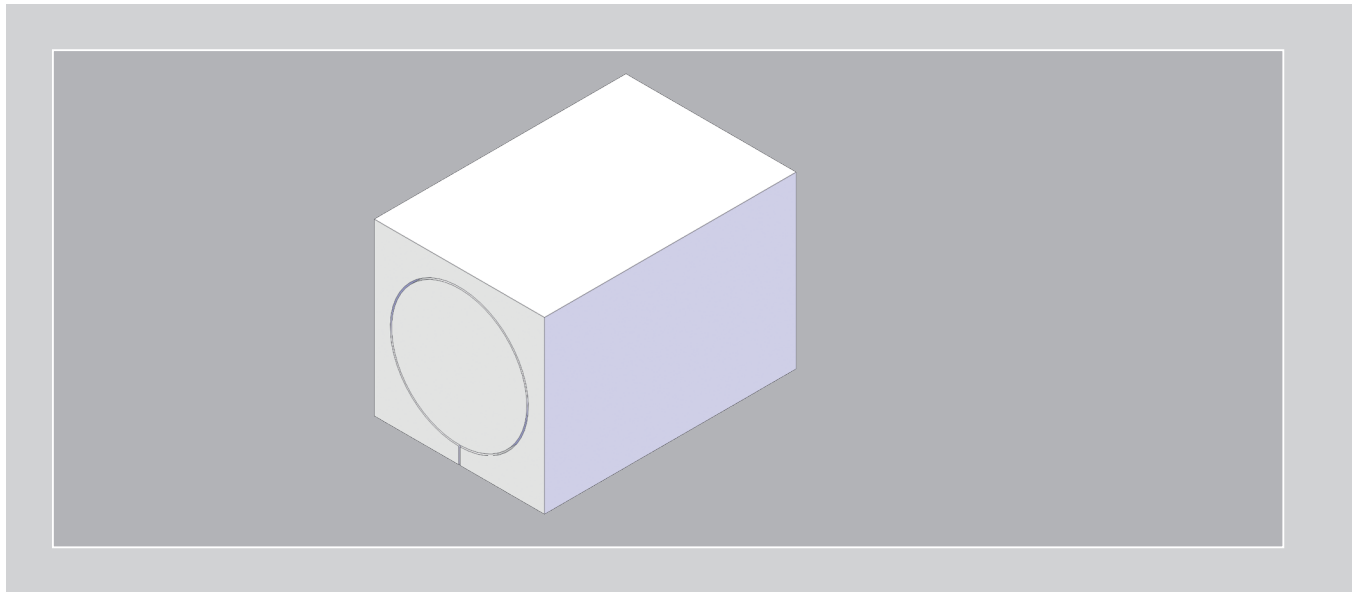

Uno hab Brickwork template block

**Uno hab Brickwork
template block 365 mm
Uno hab Brickwork
template block 490 mm**

3.2 Positioning

Note the following distances to walls and ceilings when positioning the wall stone.

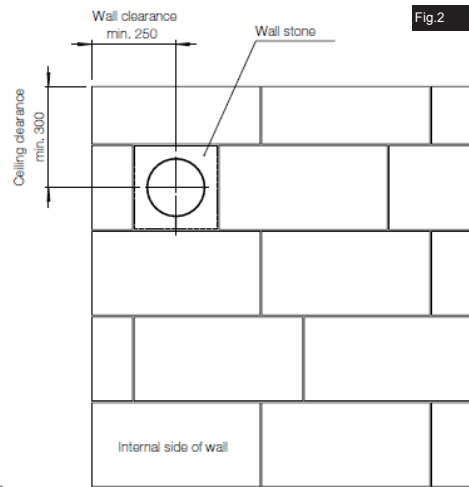

All dimensions in mm

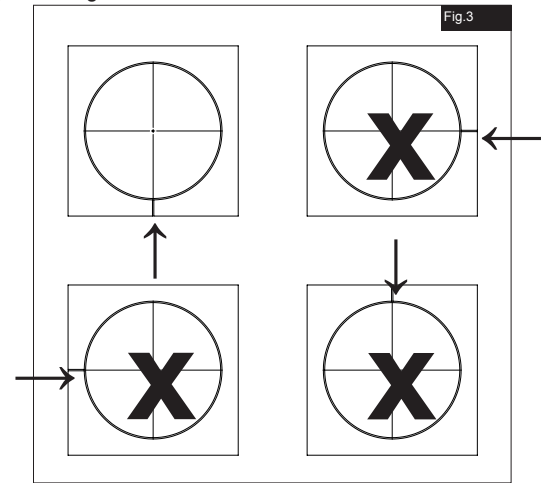

NOTE!

Align notch facing downwards.

NOTE

The wall stone must be flush with the uncovered construction wall, both internally and externally. If necessary, the wall stone must be cut to the corresponding length.

The EPS core serves to stabilise the drill hole. Only remove the Uno hab wall installation sleeve once the wall is completed or for installation!

– When installing two or more ventilation unit

The following minimum clearances must be observed when positioning two or more ventilation units or wall stones to prevent short-circuiting (see Fig. .)

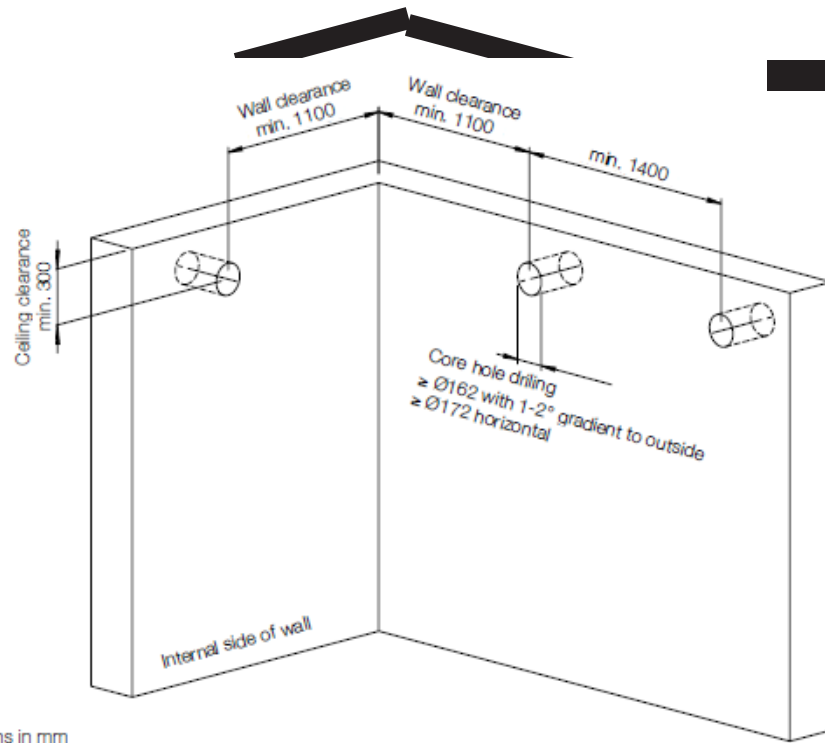

All dimensions in mm

Call: 01494 525252

Visit: airflow.com

80000781 - Issue 2 09/20



Airflow Developments Limited
Aidelle House, Lancaster Road,
Cressex Business Park,
High Wycombe, Buckinghamshire,
United Kingdom, HP12 3QP

E-mail: info@airflow.com
Telephone: +44 (0) 1494 525252

airflow.com

© Airflow Developments Limited. Airflow Developments Limited reserve the right, in the interests of continuous development, to alter specifications without prior notice. All orders are accepted subject to our conditions of sale which are available on request

